

Town and Country Planning Act 1990

The HIGH PEAK BOROUGH COUNCIL Tree Preservation (Arnside, Simmondley Village, Simmondley, Glossop) Order 2023 No 313.

High Peak Borough Council, in exercise of the powers conferred on them by section 198 of the Town and Country Planning Act 1990 make the following Order—

Citation

1. This Order may be cited as High Peak Borough Council Tree Preservation (Arnside, Simmondley Village, Simmondley, Glossop) Order 2023 No 313.

Interpretation

2.— (1) In this Order “the authority” means High Peak Borough Council.
(2) In this Order any reference to a numbered section is a reference to the section so numbered in the Town and Country Planning Act 1990 and any reference to a numbered regulation is a reference to the regulation so numbered in the Town and Country Planning (Tree Preservation)(England) Regulations 2012.

Effect

3. (1) Subject to article 4, this Order takes effect provisionally on the date on which it is made.

(2) Without prejudice to subsection (7) of section 198 (power to make tree preservation orders) or subsection (1) of section 200 (tree preservation orders: Forestry Commissioners) and, subject to the exceptions in regulation 14, no person shall—

- (a) cut down, top, lop, uproot, wilfully damage, or wilfully destroy; or
- (b) cause or permit the cutting down, topping, lopping, uprooting, wilful damage or wilful destruction of,

any tree specified in the Schedule to this Order except with the written consent of the authority in accordance with regulations 16 and 17, or of the Secretary of State in accordance with regulation 23, and, where such consent is given subject to conditions, in accordance with those conditions.

Application to trees to be planted pursuant to a condition

4. In relation to any tree identified in the first column of the Schedule by the letter “C”, being a tree to be planted pursuant to a condition imposed under paragraph (a) of section 197 (planning permission to include appropriate provision for preservation and planting of trees), this Order takes effect as from the time when the tree is planted.

Dated this 23rd day of November 2023

The Common Seal of High Peak Borough Council was affixed to this order in the presence of:

.....

Authorised by the Council to sign in that behalf

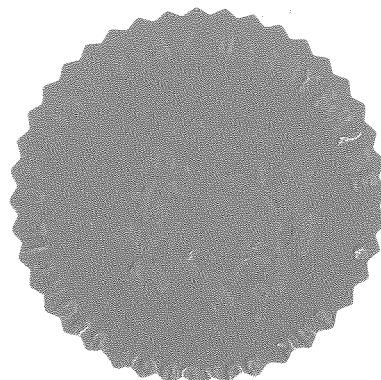

CONFIRMATION OF ORDER

This Order was confirmed by High peak Borough Council without modification on the 20th day of May 2024

OR

~~This Order was confirmed by High Peak Borough Council, subject to the modifications indicated by~~

~~on the _____ day of~~

Signed on behalf of High Peak Borough Council

W. E. B. i.
.....

Authorised by the Council to sign in that behalf

~~DECISION NOT TO CONFIRM ORDER~~

~~A decision not to confirm this Order was taken by High Peak Borough Council on the _____ day of~~

~~Signed on behalf of High Peak Borough Council~~

~~.....~~

~~Authorised by the Council to sign in that behalf~~

VARIATION OF ORDER

This Order was varied by High Peak Borough Council on the _____ day of _____ a copy of which is attached.

Signed on behalf of High Peak Borough Council.

.....

Authorised by the Council to sign in that behalf

REVOCATION OF ORDER

This Order was revoked by High Peak Borough Council on the _____ day of _____

Signed on behalf of High Peak Borough Council

.....

Authorised by the Council to sign in that behalf

SCHEDULE

Specification of trees

Trees specified individually

(encircled in black on the map)

<i>Reference on map</i>	<i>Description</i>	<i>Situation</i>
T1	Alnus sp (Alder)	NW corner of rear garden of Arnside
T2	Alnus sp (Alder)	NW corner of rear garden of Arnside

Trees specified by reference to an area

(within a dotted black line on the map)

<i>Reference on map</i>	<i>Description</i>	<i>Situation</i>
	None	

Groups of trees

(within a broken black line on the map)

<i>Reference on map</i>	<i>Description (including number of trees of each species in the group)</i>	<i>Situation</i>
	None	

Woodlands

(within a continuous black line on the map)

<i>Reference on map</i>	<i>Description</i>	<i>Situation</i>
	None	

HPBC TPO 313 - Arnside, Simmondley Village, Glossop THE GREEN

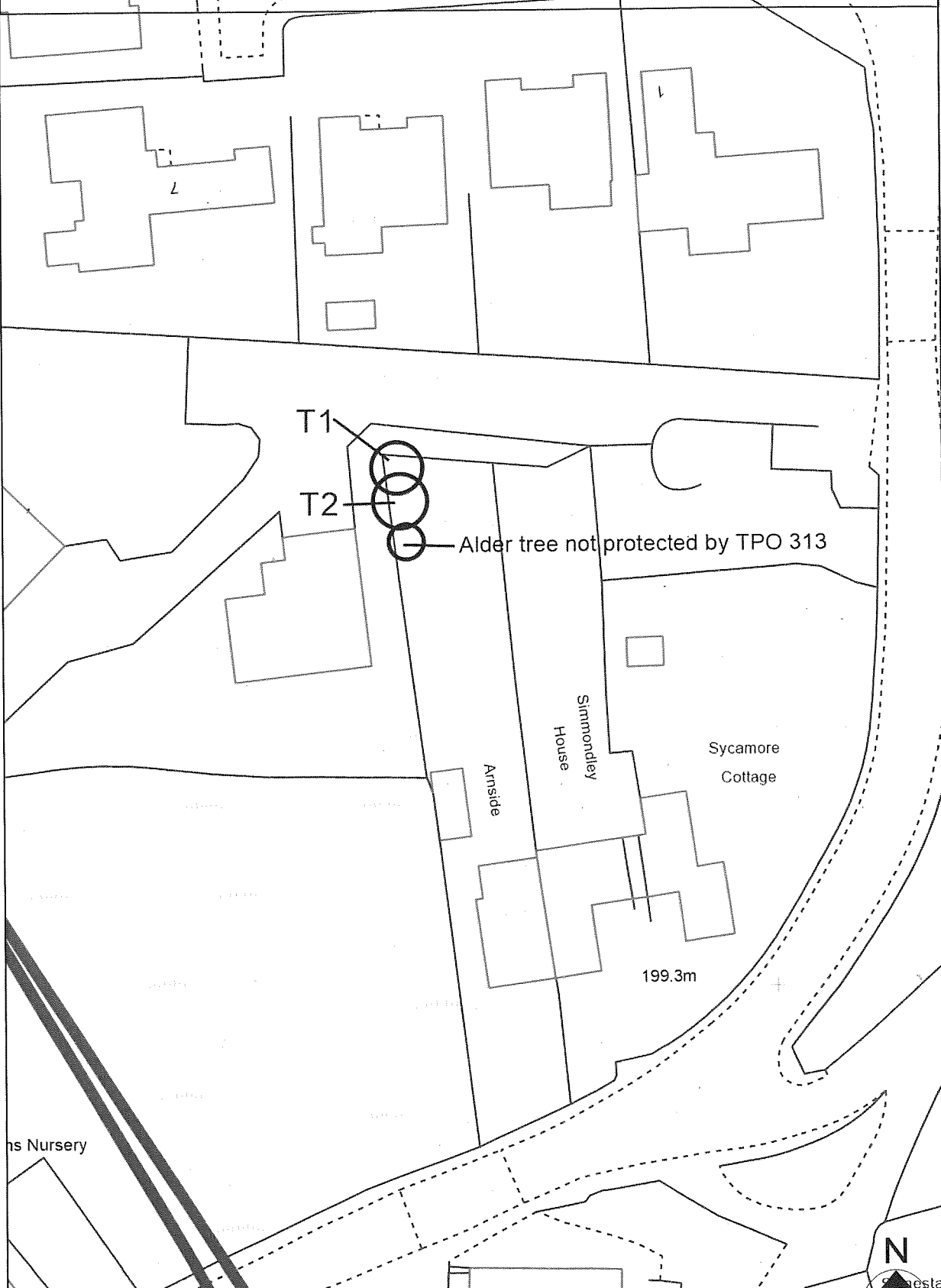

0 2.5 5 7.5 10 metres

23 November 2023

© Crown copyright and database rights 2023 OS AC0000822578

